

CP 2100 Series

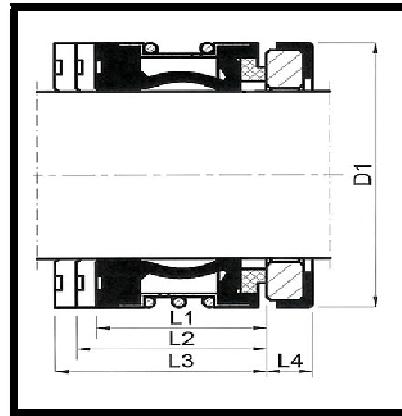

Shaft Size	Head O.D	Seat O.D.	Operating Length	Operating Length	Operating Length	Seat Thick
<i>d</i>	<i>D</i>	<i>D1</i>	<i>L1</i>	<i>L2</i>	<i>L3</i>	<i>L4</i>
10	20	21	15	27.5	35.0	5
12	22	23	15	26.5	34.0	6
14	24	25	15	29.0	34.0	6
15	25	26	15	29.0	34.0	6
16	26	27	15	29.0	34.0	6
18	32	33	20	31.5	39.0	6
20	34	35	20	31.5	39.0	6
22	36	37	20	31.5	39.0	6
24	38	39	20	34.0	44.0	6
25	39	40	20	34.0	44.0	6
28	42	43	26	36.5	44.0	6
30	44	45	26	35.5	43.0	7
32	46	48	26	35.5	48.0	7
33	47	48	26	35.5	48.0	7
35	49	50	26	34.5	47.0	8
38	54	56	30	37.0	47.0	8
40	56	58	30	37.0	47.0	8
43	59	61	30	37.0	52.0	8
45	61	63	30	37.0	52.0	8
48	64	66	30	35.0	50.0	10
50	66	70	30	37.5	50.0	10
53	69	73	30	37.5	60.0	10
55	71	75	30	37.5	60.0	10
58	78	78	33	42.5	60.0	10
60	80	80	33	40.5	58.0	12
63	83	83	33	40.5	58.0	12
65	85	85	33	40.5	68.0	12
68	88	90	33	40.5	68.0	12
70	90	92	33	48.0	68.0	12
75	99	97	40	48.0	68.0	12
80	104	105	40	47.5	77.5	14
85	109	110	40	47.5	77.5	14
90	114	115	40	52.5	77.5	14
95	119	120	40	52.5	77.5	14
100	124	125	40	52.5	77.5	14

Technical Features

- Single seal
- Un-balanced
- Single spring
- Elastomer bellows
- Bayonet drive to DIN 24960 (L2 and L3), ISO 3069
- Equivalent to John Crane type 2100

Materials

- Seal faces:** carbon graphite, tungsten carbide
- Stationary seats:** ceramic, silicon carbide, tungsten carbide
- Elastomers:** NBR, FPM, EPDM
- Metal components:** AISI 304, 316, 316Ti